

**INVERNESS
EGPE**

AD ELEV 31FT

ARP 573233N 0040251W

**AERODROME
CHART - ICAO**

COM	INVERNESS INFO
ATIS	INVERNESS TOWER
TWR	INVERNESS FIRE
LIGHTING	
APCH 05/23	HI 900m with 5 crossbars.
THR 05/23	HI green W bars.
THR 11/29	HI green W bars.
RWY 05/23	HI white final 600m yellow.
RWY 11/29	HI white 700m
TWY	Blue edge between THR 11 and THR 05 round apron. Green C/L through north apron. Guard lights and stop bars at Holds A1 and F.

Hot Spots
HS1
 Holding point E1 Vehicle Crossing Point and entry to Runway 11. Helicopters may land/depart 11 Threshold.
HS2
 Holding point F entry to main Runway. Red stop bars. Caution Runway 11 stop end lights are past the "F" red stop bars.

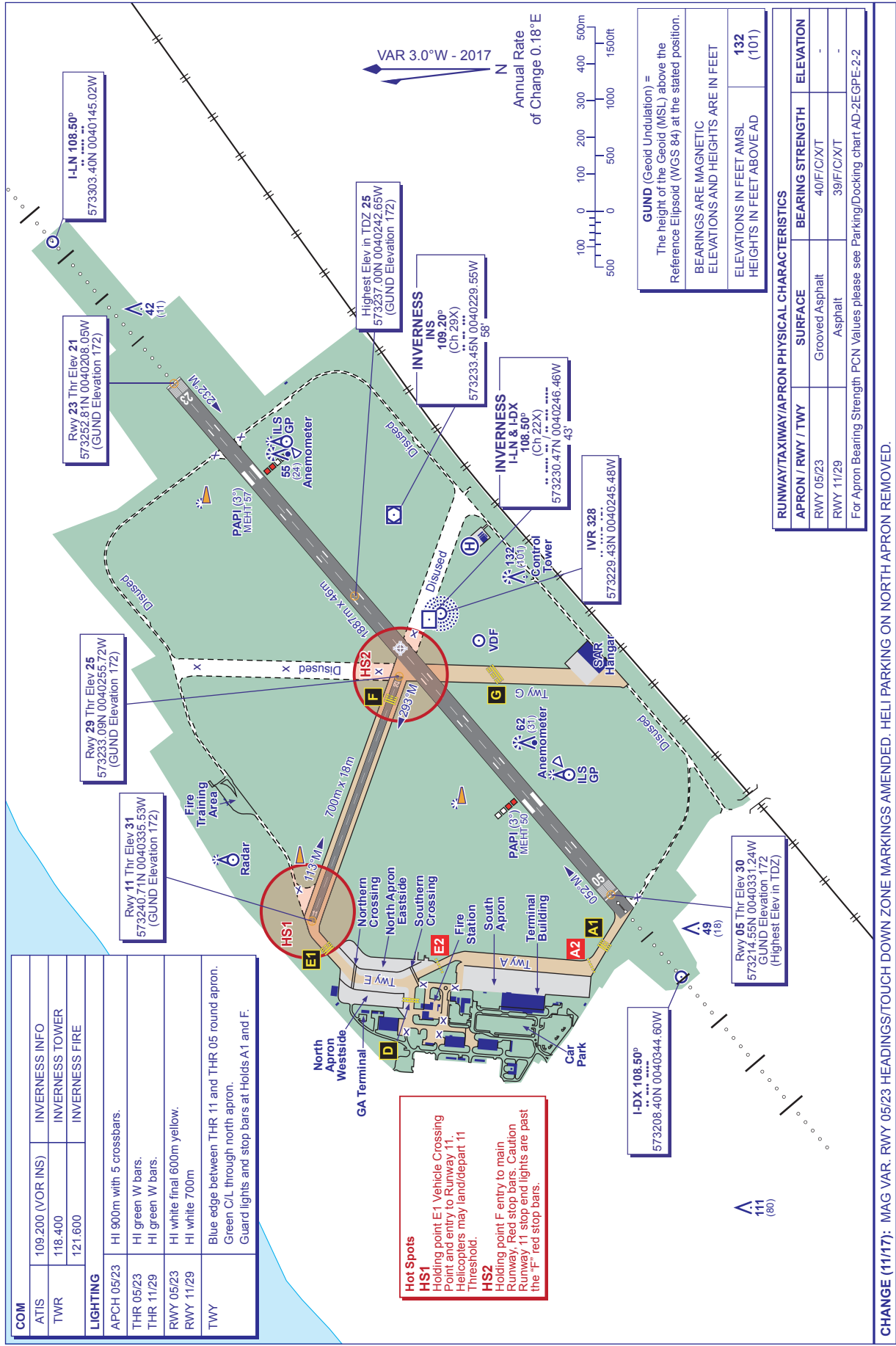

GUND (Geoid Undulation) =
The height of the Geoid (MSL) above the Reference Ellipsoid (WGS 84) at the stated position.
BEARINGS ARE MAGNETIC
ELEVATIONS AND HEIGHTS ARE IN FEET

ELEVATIONS IN FEET AMSL	132
HEIGHTS IN FEET ABOVE AD	(101)

RUNWAY/TAXIWAY/APRON PHYSICAL CHARACTERISTICS

APRON / RWY / TWY	SURFACE	BEARING	STRENGTH	ELEVATION
RWY 05/23	Grooved Asphalt	40/F/C/X/T		-
RWY 11/29	Asphalt	39/F/C/X/T		-

For Apron Bearing Strength PCN Values please see Parking/Docking chart AD-2EGPE-2-2

AERO INFO DATE 03 AUG 17

CHANGE (11/17): MAG VAR. RWY 05/23 HEADINGS/TOUCH DOWN ZONE MARKINGS AMENDED. HELI PARKING ON NORTH APRON REMOVED.